



Mamiana Park, 63 Azabu-mamianacho

Kakutei Shinkoku:
Final Income Tax Return

Final Income Tax Return

Final Income Tax Return is a procedure in which taxpayers report their total income earned from January 1 to December 31, and pay or adjust their tax amount accordingly. By adjusting the excess or deficiency of their tax amount already deducted from their employment income or other income sources, individuals will pay tax or receive a tax refund according to their final income. This procedure is called *kakutei shinkoku*, final income tax return. Both of the due dates for filing the Final Income Tax Return and the payment of income tax is March 15.

Classification of a Taxpayer

Individuals must pay income tax according to the following classifications.

Classification		Income from sources in Japan		Income from sources abroad	
		Paid in Japan	Paid abroad	Paid in Japan	Paid abroad
Resident	Non-permanent resident	Taxable	Taxable	Taxable	Amount remitted to Japan is taxable
	Permanent resident	Taxable	Taxable	Taxable	Taxable
Non-resident		Taxable in principle		Not taxable	

1. Resident: A person who has an address in Japan or has had residence continuously in Japan for one year or more.

2. Non-permanent resident: A resident who is not a Japanese national and has had an address or lived in Japan for less than five years in the last ten years.

3. Permanent resident: A resident other than a non-permanent resident.

4. Non-resident: A person other than a resident.

Direct tax return application venues

From February 16 to March 15 *Open on weekdays only

Reception: 8:30 a.m. to 4 p.m.

Consultation: Starts from 9:15 a.m.

Venue: Shiba Tax Office 5F, meeting room, 5-8-1 Shiba
Azabu Tax Office Annex, meeting room, 3-3-5
Nishi-azabu

Note: Please bring an interpreter with you if you need help with Japanese. The reception desk may close early if it is crowded. The 1F of the Tokyo Regional Taxation Bureau will be open for consultations and receptions on February 21 and 28.

For general inquiries in English about national tax, please call the Tokyo Regional Taxation Bureau consultation service, Tel: 03-3821-9070 weekdays; 9 a.m. to 5 p.m.

For more information, please visit the National Tax Agency’s website at <https://www.nta.go.jp>

Inquiries: Shiba Tax Office Tel: 03-3455-0551
Azabu Tax Office Tel: 03-3403-0591

Minato Monthly is delivered with The Japan Times/International New York Times on the first of each month. It is also available at municipal facilities, post offices and subway stations (Akabanebashi, Akasaka, Akasaka-mitsuke, Aoyama-itchome, Azabu-juban, Daimon, Gaien-mae, Hiroo, Kamiyacho, Mita, Nogizaka, Omotesando, Roppongi, Shimbashi, Shiodome, Shirokanedai and Shirokane-Takanawa) in Minato City. The articles appearing in the Minato Monthly are also found on the Minato City Web: www.city.minato.tokyo.jp

Minato Monthly home-delivery service: For free delivery of Minato Monthly to foreign resident’s homes in Minato City, contact Minato Call or Minato Monthly by e-mail at kuminkoho@city.minato.tokyo.jp. Please write “Minato Monthly” in the subject line.

Minato Call

CITY INFORMATION SERVICE

03-5472-3710

ROAD SAFETY

Minato City Traffic Accident Insurance 2021

Reasonably-priced Personal Traffic Accidental Insurance and Bike Liability Insurance Plan are available for Minato City residents, workers, and students. Depending on the accident circumstances, the insurance covers liability compensation for cases of inflicted injury or damage to another person or his/her property as a result of bicycle or wheelchair-related accident.

For more information, please see the brochure at Regional City Offices or visit the Minato City Web.

Note: You cannot purchase only Bike Liability Insurance Plan.

Eligibility: Minato City residents, workers, and students as of April 1, 2021

Insurance term: Midnight on April 1, 2021 to midnight on March 31, 2022

Changes in 2021

- In addition to residents, eligibility will be expanded to people working or studying in Minato City. Applications for people working or studying in Minato City are only accepted at financial institution service counters in Minato City.
- XJ plan will be established.
- Insurance fee will be revised.
- “Accident Damage Compensation Plan” will be automatically added to all plans.

Application

	Resident		Worker, student in Minato City
	Personal Enrollment	Group Enrollment (10 people or more)	
Reception	Regional City Offices, banks, credit unions, Yucho Bank, and post offices in Minato City	Regional City Offices	Regional City Offices, banks, credit unions, Yucho Bank, and post offices in Minato City
Application Period	Regional City Offices: Until 3/31 Financial institutions Until 3/22	Until 3/31	Until 3/22

Insurance Plan and Premiums

Please select up to one insurance plan.

	Insurance plan	Annual insurance fee	Maximum compensation amount
A	Accidental Insurance A+ Accident Damage Compensation Plan	¥900	¥1.5 million + ¥6 million
B	Accidental Insurance B+ Accident Damage Compensation Plan	¥1,500	¥3.5 million + ¥6 million
C	Accidental Insurance C+ Accident Damage Compensation Plan	¥2,500	¥6 million + ¥6 million
XJ	Accidental Insurance X + Accident Damage Compensation Plan+ Bike Liability Insurance	¥1,400	¥350,000 + ¥6 million + ¥100 million
AJ	Accidental Insurance A + Accident Damage Compensation Plan+ Bike Liability Insurance	¥1,900	¥1.5 million + ¥6 million + ¥100 million
BJ	Accidental Insurance B + Accident Damage Compensation Plan+ Bike Liability Insurance	¥2,500	¥3.5million + ¥6 million + ¥100 million
CJ	Accidental Insurance C + Accident Damage Compensation Plan+ Bike Liability Insurance	¥3,500	¥6 million + ¥6 million + ¥100 million

The information presented here is an overview.
For more information please inquire at Sompo Japan Insurance Inc. Tokyo Public Institutions
Department Production & Marketing Division
Tel: 03-3349-9666, weekdays from 9 a.m. to 5 p.m.

Inquiries: Minato Call, Tel: 03-5472-3710

Authorization number: SJ20-09711 as of January 6, 2021

CHANNEL 11

Minato Public TV Program Guide

J:COM MINATO-SHINJUKU FEBRUARY schedule

Program	Time	Program Summary
With Our Residents - Feel Your MINATO 20 min. bilingual program	10:30 a.m., 1:30 p.m., 3:30 p.m., 5:30 p.m., 9:30 p.m.,	<i>Komusubi</i> , child-rearing support service is conducted between “people who want to provide childcare service” and “people who need childcare service.” Introducing opinions of both sides through the program.
Minato-ku Koho Topics, Topics in Minato City 20 min. program	10 a.m., 1 p.m., 3 p.m., 5 p.m., 9 p.m.,	<Public Announcements> Delivers important announcements, new information, or events in Minato City. 1-10: Mayor’s press release 11-20: Introducing audio library 21-28: Traffic accident insurance for residents

Note: Programs may change without notice. You can also see the programs broadcasted by this channel on the Minato City Web or Youtube.
The Koho Topics are also broadcasted in the Chii-bus and the Odaiba Rainbow bus. Video/DVD lending is available at the Office of the Mayor, Regional City Offices, and each public library. Videos/DVDs for the past year can be rented.

Inquiries: J:COM Minato-Shinjuku, Tel: 0120-999-000 URL: <https://www.jcom.co.jp/english/>

ANNOUNCEMENT

School Enrollment Notification for 2021

The Minato City Board of Education has sent out enrollment notifications, or *shugaku tsuchisho*, to eligible families applying for Minato City municipal elementary or junior high schools in April 2021. This document needs to be submitted to school, so please keep it safe. If you have not received the notification or have lost it, please contact us.

Eligibility

1. First grade of elementary school: children born between April 2, 2014 and April 1, 2015
 2. First grade of junior high school: children born between April 2, 2008 and April 1, 2009
- * If your child will enroll in a national, Tokyo metropolitan, private elementary or junior high school, please submit the Enrollment Certificate or Acceptance Certificate issued by the school.
- * If your child is of a foreign nationality and the guardian wishes to enroll her/him in a municipal elementary or junior high school, please contact us.

Inquiries: Educational Affairs Subsection,
Tel: 03-3578-2726 to 2729

SUPPORT

Notification of Minato City Gift Certificates Special Benefits Project

Minato City will conduct Gift Certificates Special Benefits Project which was implemented as a lifestyle support measure of the COVID-19 impact.
Eligibility: Households wherein all members were continuously recorded in the Minato City Basic Resident Register from January 1 to November 19, 2020, and who were not subject to the residence tax as of November 19.

*However, if the municipal resident tax has been imposed on anyone in household, or if a person subject to the municipal resident tax has dependents, then all members of household are not eligible for the gift certificates.

*Those who are receiving welfare benefit are not eligible for the gift certificates.

Benefits: City gift certificates ¥20,000 for single household, ¥30,000 for multi-person household

Schedule from application to benefits

1. The City has sent the Application Form of Minato City Gift Certificates Special Benefits Project from January 18 to eligible households.
2. Fill out the application form and return by March 17 using the enclosed return envelope.
*Submit by the deadline as application that have passed the deadline cannot be accepted.
3. Application will be confirmed by the city.
4. When the benefits have been prepared, gift certificates will be sent by registered mail from mid-February to the end of March.

*For details, please see the documents enclosed with the application form.

*Examples of how to fill in the application documents in English, Chinese, and Korean are available at the Minato City web.

Inquiries: Gift Certificates Special Benefits Subsection,
Tel: 03-3578-2009, Fax: 03-3578-2034

MINATO BULLETIN BOARD



Programs may change without notice. All events listed on this page are conducted in Japanese. For more information, please see the Minato City Web.

Minato City Events

SCHEDULE FOR FEBRUARY

Please wear mask and take your temperature before coming.
All events listed on this page are conducted in Japanese. Programs may change without notice.

Date	Time	Program	Place/Capacity
Library Events			
6	2 p.m.	Our Idiot Brother – 2011, U.S., 90 min.	Takanawa/20
7	2 p.m.	Lucy – 2015, U.S., 89 min.	Azabu/15
12	2 p.m.	Origami class for adult Eligibility: Junior high school students and over	Takanawa/6
13	1 p.m.	Tokyo Night Cruising – 2018, Japan, 43 min.	Minato/45
20	2 p.m.	Rock seminar Capacity: First 45 people	Minato/45
27	1 p.m.	The Sting – 1973, U.S., 129 min.	Minato/45
27	2 p.m.	Storytelling	Akasaka/10
28	2 p.m.	It Could Happen To You – 1994, U.S., 101 min.	Mita/30

CITY EVENTS

Kissport Events

Shibakoen Plum Festival

Everyone is welcome. Come to the venue directly.
Fee: ¥500 for tea and sweet
*Cancelled in case of rough weather
Date & time: February 19 and 20, 11 a.m. to 3 p.m.
Place: Plum grove at Tokyo Metropolitan Shiba Park
Miniature Zoo in Takanawa
Date & time: March 6, 10:30 a.m. to 3:30 p.m. *Cancelled if rainy
Place: Mitadai Park, 4-17-28
Eligibility: Elementary students and under and their guardian
Come to the venue directly.
Inquiries: Kissport, Tel: 03-5770-6837

INTERFM 89.7 MHz

Minato Voice

Time: 5:56 to 5:59 p.m., 3 min. program
Monday & Thursday: English, **Tuesday:** Japanese
Wednesday: Chinese, **Friday:** Korean
* Programs may change without notice.
Inquiries: Public Relations Subsection, Tel: 03-3578-2041

RECYCLE

Sale of Recycled Bikes

About 30 recycled bikes in good condition that are reclaimed and repaired are sold.
Date and time: February 14, 10 a.m.
The drawing starts a 10:30 a.m. Minato City residents have priority.
Place: Minato Recycling and Management Office Working Contact, 3-9-6 Moto-azabu
Inquiries: Minato Call, Tel: 03-5472-3710



MEMBERS WANTED

The Minato City Internationalization Promotion Advisory Conference

In order to verify efforts for the internationalization promotion measures that were implemented based on the “Minato City Internationalization Master Plan,” the Minato City Internationalization Promotion Advisory Conference, composed of members including publicly recruited Minato City residents, has been set up. Minato City is looking for members who can participate from April 2021 (planned).
Eligibility: People aged 20 and over living, working or studying in Minato City who can participate in the meetings held twice a year.
Number of Members: Ten, consisting of five foreign and five Japanese nationals.
Term: April 1, 2021 (planned) to March 31, 2023
Application Method:
Fill out the following information on a horizontal sheet of A4 paper free form and submit either by email or fax: 1. Name; 2. Address; 3. Nationality; 4. Gender; 5. Age bracket; 6. Name and address of your company or school, if you work or study in Minato City; 7. Connection with Minato City such as experience as a committee member; 8. Phone number; 9. Your opinions toward the “Minato City Internationalization Master Plan (Draft) FY2021-FY2026.” Electronic application is also possible at <https://www.shinsei.elg-front.jp/tokyo2/uketsuke/form.do?id=1610520484037>, registration procedures are in Japanese.
Application Deadline: Must arrive by February 26
Inquiries: Global Community Planning Subsection, Tel: 03-3578-2308, Fax: 3438-8252
Note:
1. Application documents will not be returned.
2. Personal information provided will only be used for the Minato City Internationalization Promotion Advisory Conference’s review committee and for contacting individuals to confirm their application details.
3. The “Minato City Internationalization Master Plan (Draft) FY2021-FY2026” is available on the Minato City website at the following URLs.
Japanese version:
<https://www.city.minato.tokyo.jp/kouchou/kuse/kocho/kuseiken/documents/201201-kokusai-zenbun01.pdf>
English version:
<https://www.city.minato.tokyo.jp/kouchou/kuse/kocho/kuseiken/documents/201201-kokusai-zenbun02.pdf>
4. Minato City Internationalization Promotion Advisory Conference members who attend the meetings will receive remuneration.

Minato Public Health Center

SCHEDULE FOR FEBRUARY

Eligibility: Registered residents or registered foreign residents of Minato City
Minato Public Health Center: 1-4-10 Mita, Tel: 03-6400-0083

	Eligibility	Date	Time	Place
Stomach, colon cancer	Residents aged 35 or older Capacity: 20 people	Weekdays in March	8:30 to 9:30 a.m.	(B)

Appointment for HIV test, Tel: 03-6400-0081

Eligibility	Examination date	Exam. results available	Place
HIV/STD test*	Open to all	3/4, 3/18	9:30 to 10:30 a.m. (A)

*The result is two weeks later from the check-up day at the Minato Public Health Center
Other examinations, Tel: 03-6400-0084

	Eligibility	Date	Time	Place
Checkup and consultation for babies/infants	An eligible resident must receive the notification - 4-month-old: Born in November, 2020 - 18-month-old: Born in August, 2019 - 3 years old: Born in February, 2018		A notification will be sent to eligible.	(A)
Birthday dental checkup	Babies aged one and two years old born in February	3/17	Reservation required	(A)

(A) Minato Public Health Center
(B) Genki Plaza Medical Center For Health Care, Jimbocho Mitsui Building, 1-105 Kanda-Jimbocho, Chiyoda City
Note: You need to apply and make an appointment in advance.
Inquiries and appointment: Minato Public Health Center, Tel: 03-6400-0084
For inquires in English, contact Minato Call, Tel: 03-5472-3710

Himawari Medical Facilities Consultation Service

If you are looking for a doctor or pharmacy, you can call the Himawari Himawari informs medical institutions and Japanese healthcare system.
Tel: 03-5285-8181, 9 a.m.-8 p.m.

IMPORTANT NOTICE

Overcoming the COVID-19 pandemic

- Let's all keep the following seven points in mind.
1. Please refrain from leaving home unless necessary, especially after 8 p.m.
 2. When you take off your mask for a meal, wash your hands with soap or an alcoholic disinfectant before eating. Fold your mask inside and avoid speaking in a loud voice. If you can't keep a distance, hold a fan or similar object in front of your mouth to avoid your saliva from spreading when you talk.
 3. Each of us should practice new routines*.
- *Habits that prevent the spread of infection in our daily lives and workplaces in order to overcome the COVID-19 pandemic.
4. Wash your hands frequently with soap and alcoholic disinfectant. Keep cough etiquette.
 5. Maintain appropriate distance. If you are not wearing a mask, keep a distance of 2 meters.
 6. Avoid the Three C's: (1) Closed spaces with poor ventilation (2) Crowded spaces with many people nearby (3) Close-contact settings such as close-range conversations
 7. If you have a fever or other cold symptoms, take a day off from work or school. Check and make a record of your body temperature every day.

IMPORTANT INFORMATION

National Health Insurance Defaults

Below are the consequences of National Health Insurance (NHI) delayed or unpaid premiums.

1. If you fail to complete the payment by the due date, a demand for payment notice will be sent to you.
2. A national health insurance eligibility certificate may be issued if the unpaid term exceeds a year.

Note: You can receive medical services provided by health insurance with the eligibility certificate. However, the total amount for the provided services needs to be paid at the medical institutions and you can claim the difference eligible to be covered by NHI to be applied to the past due amount.

3. In addition to the above, in extreme cases of continuous defaults, your property may be seized without any previous notice.

To avoid the above, make sure to pay your NHI bills by their due date. Please contact us if you cannot make the payment. The National Health Insurance system is supported by the health insurance members' premiums

Inquiries: Eligibility and Premium Subsection, Tel: 03-3578-2647 to 2649
Delinquent Premium Clearance Subsection, Tel: 03-3578-2536 and 2537, 2650 to 2653

COLUMN

Introducing Traditional Arts and Crafts

Tokyo Ginki

Tokyo *ginki* is a silverware mainly made in Tokyo. It spread when silverware craftsmen and metalworkers made combs, hairpins, etc. Today many products are made by using the techniques of *tankin* hammering, *chokin* engraving, and *kiribame* fitting.

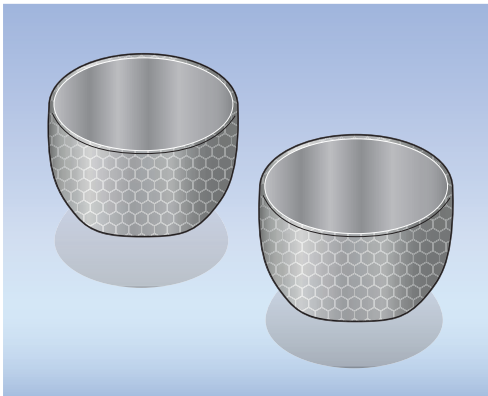

RESIDENT SERVICES

School Indoor Swimming Pools Open to the Public

The following school swimming pools are open to residents and workers in Minato City year-round. Please use the facilities to maintain your health.

Operating hours

School	Operating hours (Weekdays)	Operating Hours (Weekends)
Konan, Hommura, and Akasaka ES	Thu and Fri 5 to 8 p.m.	Sat, Sun, and an opening day coinciding with a holiday 10 a.m. to noon, 1 to 3 p.m., 3:30 to 5:30 p.m., and 6 to 8 p.m.
Onarimon JHS	Tue to Fri 6:30 to 8:30 p.m.	
Takamatsu and Koryo JHS	Thu and Fri 6:30 to 8:30 p.m. *Except for 2nd Fri for Takamatsu JHS	
Odaiba Gakuen Koyo JHS	Sat and Sun only, 10 a.m. to noon, 1 to 3 p.m., 3:30 to 5:30 p.m., and 6 to 8 p.m.	
	Thu and Fri between July 21 and August 31, 1:30 to 3:30 p.m. and 3:45 to 5:45 p.m.	

*ES: elementary school, JHS: junior high school
Note: Please confirm the exact opening schedule at each swimming pool, municipal facilities, or Minato City Web before you go. The schedule may change due to school events

Fees

Fee for two hours: ¥500 for adults, ¥100 for elementary, junior high and high school students.

Free admission for preschool children, 65 years old and over and people with disabilities residing in Minato City. The first and third Sundays are admission free days for Minato City residents. The second and fourth Saturdays are admission free for elementary, junior high and high school students residing in Minato City.

A registration card is required for high school students and above. If you don't have a registration card, bring your ID that proves your residence or workplace in Minato City. A card will be issued on the reception.

Notes for usage of Minato City swimming pools

- Please wear swimsuits and caps.
- Do not bring flotation rings and other swimming aids
- Children under 3 and toddlers wearing diapers may not enter the pools.
- Children grade 3 of elementary school and under must be accompanied by an adult when swimming. An adult may accompany up to 2 children.
- Junior high school students and under using the pool facilities at night must be accompanied by an adult.
- No vehicle or bicycle parking space available.

Inquiries: Sports Promotion Subsection, Tel: 03-3578-2747

Population of Minato City

AS OF JANUARY 1, 2021

Total: 259,036

Japanese Residents: 240,318

Male: 112,362 / Female: 127,956

Registered Foreign Residents:

18,718

Male: 9,749 / Female: 8,969

